

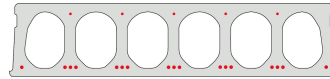

FS265-1200



Technische Infos

Höhe (Dicke)	265mm
Breite	1200mm
Feuerwiderstand	1 Stunde (2 Stunden auf Anfrage)
Expositionsklasse	XC1, XC2, XC3 (andere auf Anfrage)
Transportgewicht	3,35 kN/m ²
Gewicht /m	4,02 kN/m
Bemessungsgewicht	3,55 kN/m ² (inklusive Füllbeton)
Hohlraumfüllung	26,15 l/m
Füllbeton	8,2l/m ²
Betongüte	C 50/60
Stahlqualität	f(pk) 1860

Keurmerken



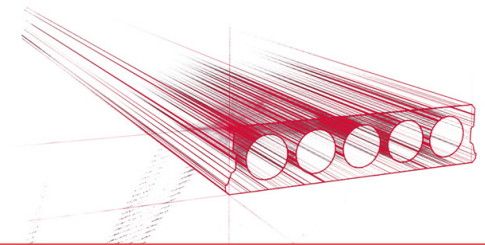

Spannweiten

Zie hiervoor onze online rekenmodule



Passplatten

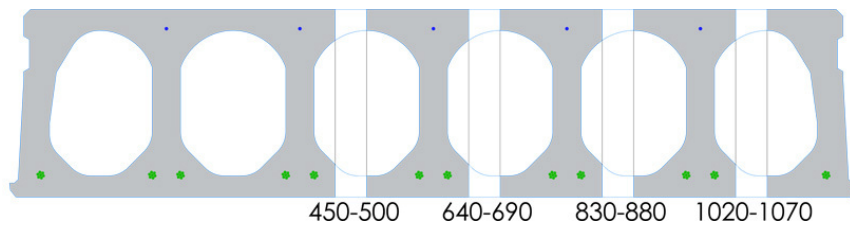

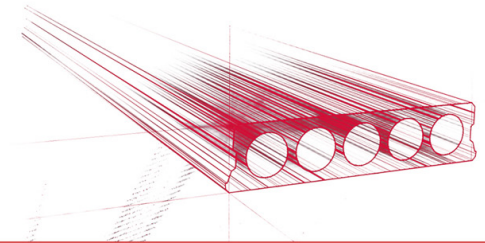

Bohrvorschriften

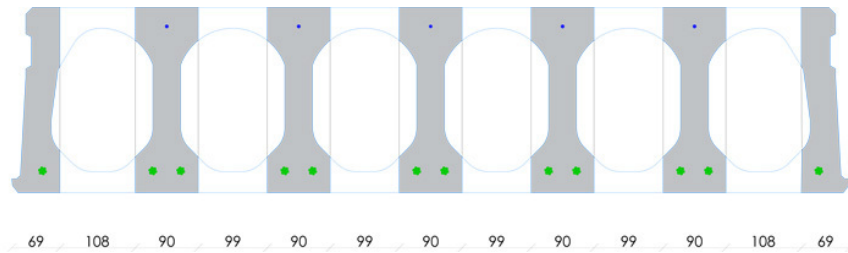

Bewehrungspositionen

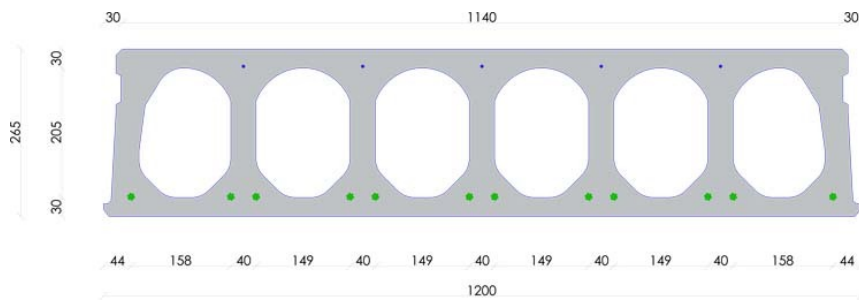



Zubehör

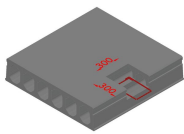

Koppelsparung
(hamerkop)

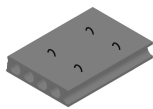

Passplatten -
Spannbeton-Hohlplatte

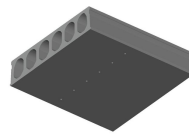

Entwässerungsöffnungen

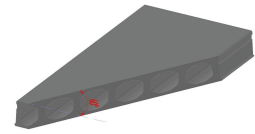

Schrägschnitte

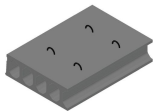

Hubschlaufen

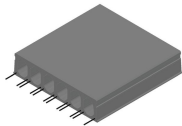

Ausstehende Bewehrung

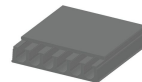

Verjüngte Oberseite

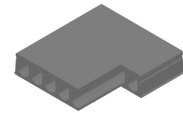

Eckaussparungen

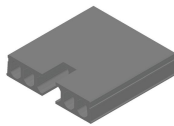

Kopfaussparung

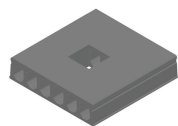

Mittelaussparung

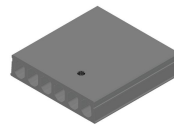

Rundaussparung + E-
Dose

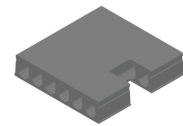

Randaussparung

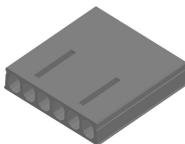

Geöffnete Hohlkammern

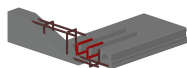

Open kanalen met
inhangwapening

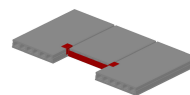

Wechseleisen
Spannbeton-Hohlplatten

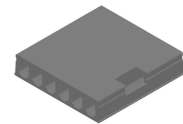

Vertiefte Aussparungen



Vorrat

	Produktion	Abnehmbar	Vorrätig
Malle 1			
Malle 2	X	X	
Frederickx			
Tessenderlo	X	X	

