



FS150-1200



Technische Infos

Höhe (Dicke)	150mm
Breite	1200mm
Feuerwiderstand	1 Stunde (2 Stunden auf Anfrage)
Expositionsklasse	XC1, XC2, XC3 (andere auf Anfrage)
Transportgewicht	2,60 kN/m ²
Gewicht /m	3,12 kN/m
Bemessungsgewicht	2,70 kN/m ² (inklusive Füllbeton)
Hohlraumfüllung	7,56 l/m
Füllbeton	4,1 l/m ²
Betongüte	C 50/60
Stahlqualität	f(pk) 1860

Keurmerken





Spannweiten

Zie hiervoor onze online rekenmodule



Passplatten

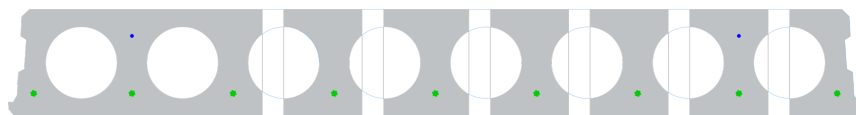

350-380 490-520 640-670 780-810 920-950 1060-1090



Bohrvorschriften

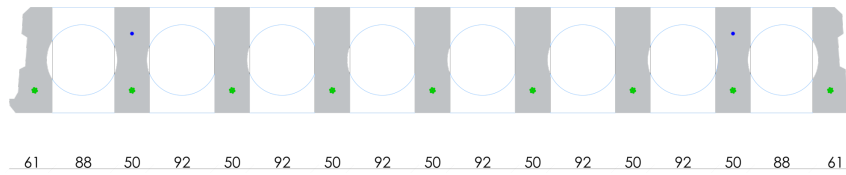

Bewehrungspositionen

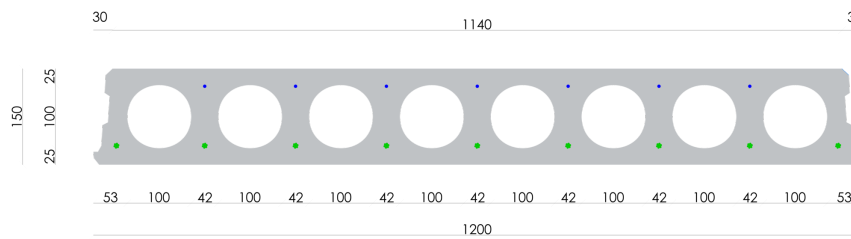

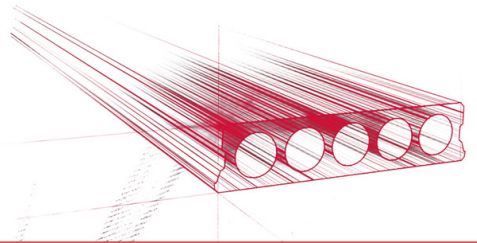

Zubehör

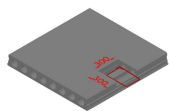

Koppelsparung
(hamerkop)

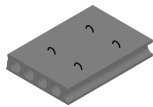

Passplatten -
Spannbeton-Hohlplatte

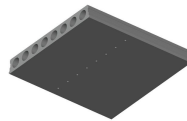

Entwässerungsöffnungen

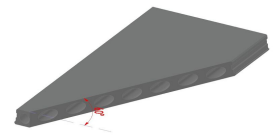

Schrägschnitte

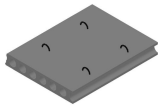

Hubschlaufen

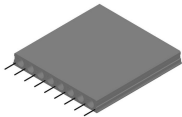

Ausstehende Bewehrung

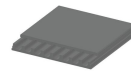

Verjüngte Oberseite

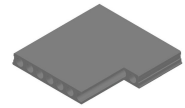

Eckaussparungen

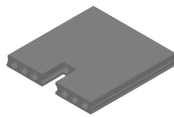

Kopfaussparung

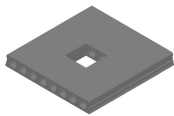

Mittelaussparung

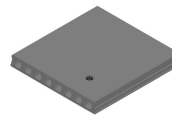

Rundaussparung + E-
Dose

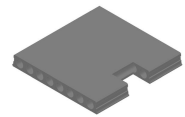

Randaussparung

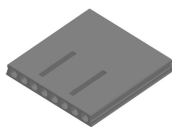

Geöffnete Hohlkammern

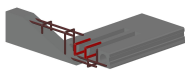

Open kanalen met
inhangwapening

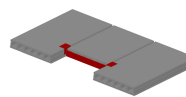

Wechseleisen
Spannbeton-Hohlplatten

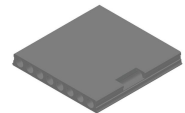

Vertiefte Aussparungen



Vorrat

	Produktion	Abnehmbar	Vorrätig
Malle 1			
Malle 2	X	X	
Frederickx			
Tessenderlo	X	X	

